



Wilbury Grove

Guide price £650,000

Lextons Land and New Homes. Guide Price £650,000 – £700,000

Chain free and fully renovated with an exemplary attention to detail, this exceptional three storey home sits tucked away on the cobbled street of a charming 19th century mews in the heart of Hove. Ready for you to simply move in and unpack, a superbly light filled and fluid layout blends oak accents, wool carpets and column radiators with luxurious bath/shower rooms and a beautifully designed kitchen. A wonderful open plan ground floor lends a hugely sociable feel and has an Amtico herringbone wood floor and sliding doors to the Mews, while a NEST thermostat is the perfect finishing touch. The hubbub of Church Road's cafe culture, the beach and seafront are only a leisurely stroll from your door, and the mainline station is only just over half a mile.



4



2



1



1



C

Wilbury Grove, BN3

£650,000

Ground Floor



First Floor

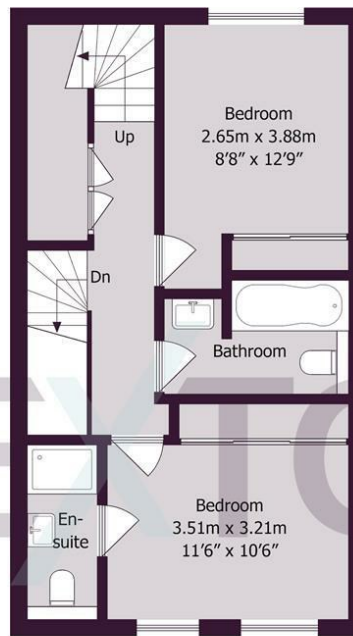

Second Floor

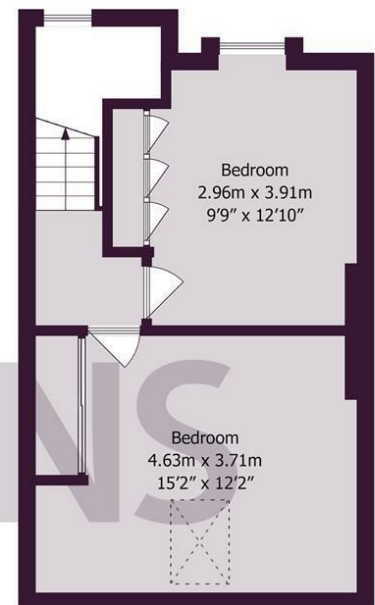

Approximate gross internal floor area 114.5 sq m/ 1232 sq ft

Whilst every care has been taken to ensure accuracy, dimensions are approximate and for illustrative purposes only.

Created by Property Photography UK for Lextons. All rights reserved.

Meet us here...

174 Church Road
Hove
BN3 2DJ

We aim to make our particulars both accurate and reliable. However they are not guaranteed; nor do they form part of an offer or contract. If you require clarification on any points then please contact us, especially if you're traveling some distance to view. Please note that appliances and heating systems have not been tested and therefore no warranties can be given as to their good working order.